



- Fully Stabilized Nose & Pocket
- Hammerless Pin for Safe & Easy Installation
- More Details on Reverse



RVR 1380797



RVR 350PTM

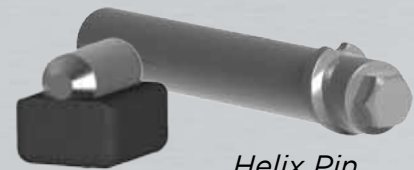

Lock

Helix Pin

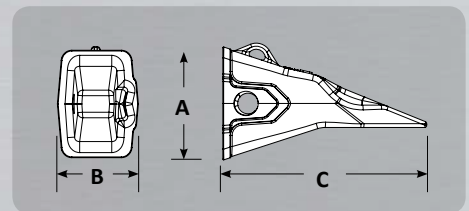
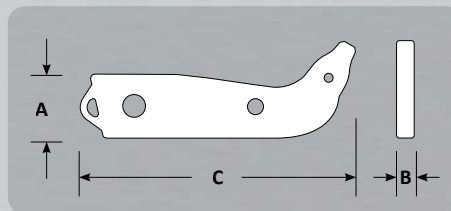

Part Number	Description	Weight	A	B	C
RVR 1380797	Ripper Shank	125 lbs	6.86"	2.92"	28.24"
RVR 350PTM	Ripper Tooth	29 lbs	6.17"	4.72"	14.13"
RVR 350PTMC12	Ripper Tooth with Carbide	31 lbs	6.17"	4.72"	14.13"
RVR 350NOSE	Ripper Nose	17 lbs	6.10"	2.92"	8.30
RVR 350P	Helix Pin	0.8 lbs			
P2RL	Rubber Lock				



**BLACK CAT**  
WEAR PARTS



**REVOLUTION**  
BLACK CAT HAMMERLESS PATENTED TECHNOLOGY

- Fully Stabilized Nose & Pocket
- Hammerless Pin for Safe & Easy Installation
- Patented Technology

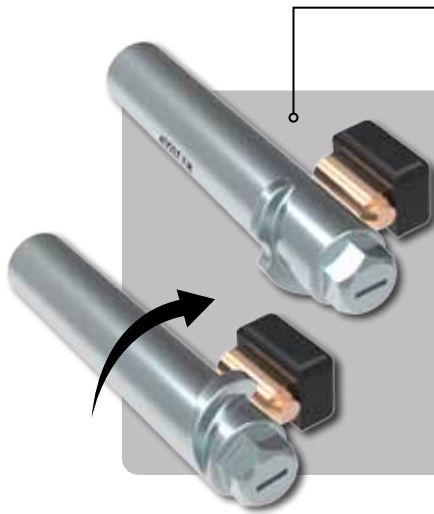
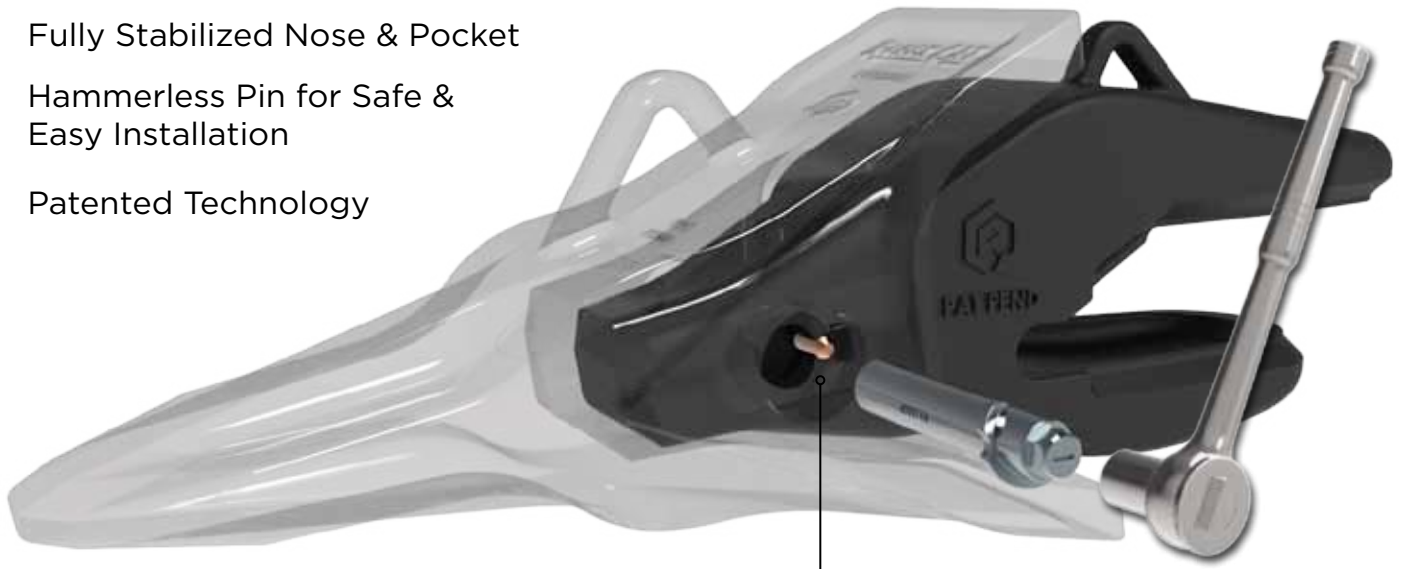

### Hammerless Pin & Lock

- Fully hammerless installation & removal for safe and easy use.
- Accept both imperial or metric socket, female square drive on opposite end.
- Lock and pin may be used on either side of nose.
- Locks with 180° clockwise turn of pin with socket wrench.
- Pin removal pulls out excess material around the pin head.

### Fully Stabilized Nose & Tooth Pocket

- Primary contact for frontal loads.  
Bottom out fit with pocket mitigates fit erosion through service life.
- Secondary contact areas for off center frontal loads.  
Planer bearing areas provide longer service life.
- Redundant frontal load bearing if the primary and secondary areas are worn from tooth overuse.
- Front = Primary bearing area for vertical tooth loads.  
Rear (opposite side) = Reactive load bearing area for vertical loads.
- V design forces the tooth to center on the nose when heavy side forces are encountered. Preventing pin loading and increases fit integrity.

